

Autism Friendly Pack

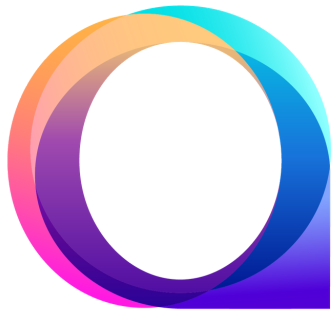

National
Autistic
Society

Autism
Friendly
2019



**Museum of Scottish
Lighthouses
COVID-19 PACK**

Introduction

In 2018 the Museum of Scottish Lighthouses became the first Museum in Scotland to achieve Autism friendly status! We are proud of this accolade and have been extremely happy to hear that the changes we have made make visiting easier for people with autism.

COVID-19 has been a challenge to the Museum sector in general. In terms of our Museum it has led to total change in our operation as a visitor attraction. Whilst this change will be difficult for all visitors, we appreciate that for people with autism it could be particularly challenging.

In an effort to keep our Museum accessible we have updated our Autism friendly pack with new information relating to COVID-19. We will provide as much certainty to a visit as possible when considering the uncertain variables at present!

We hope this pack proves useful!

When is the Museum Open?

For the foreseeable future the museum will be open at the following times:

Open

Monday - CLOSED

Tuesday - CLOSED

Wednesday - 10am-5pm

Thursday - 10am-5pm

Friday - 10am-5pm

Saturday - 10am-5pm

Sunday - 10am-5pm

If you are unsure call us on

01346 511022

or email manager@lighthousemuseum.org.uk

Lighthouse Tours

Before you can visit you will need to book your visit and pay for your tickets. The Museum is encouraging people to do this in a peer group, so make sure you book all the places you need for your group.

You can book your tickets on our website:
www.lighthousemuseum.org.uk/online-tickets/

Lighthouse Tours run at:

10am	3pm
10.30am	3.30pm
11am	4pm
11.30am	4.30pm
12pm	
12.30pm	
1pm	
1.30pm	
2pm	
2.30pm	

The Admission Prices are as follows:

Adult: £9-00

Concession: £7-00

Student: £7-00

Child: £4-00

Family (2 adults, up to 4 children): £20-00

Booking slots subject to availability

Museum Only

We also offer Museum only slots which are slightly cheaper. It will mean you do not get to visit the lighthouse. These tickets can be booked on our website too!

Museum only slots start at the following times:

10.15am	Admission Prices for Museum Only:
10.45am	Adult: £5-00
11. 15am	Concession: £4-00
11.45am	Student: £4-00
12.15pm	Child: £2-00
12.45pm	Family (2 adults, up to 4 children): £12-50
1.15pm	
1.45pm	*Booking slots subject to availability*
2. 15pm	
2.45pm	*Slots capped at 10*
3.15pm	
3.45pm	
4.15pm	

When Visiting the Museum

1. Before you come to the Museum you must book your visiting slot on our website. You will also pay for your visit online and should retain a virtual or paper receipt and bring it when you visit.

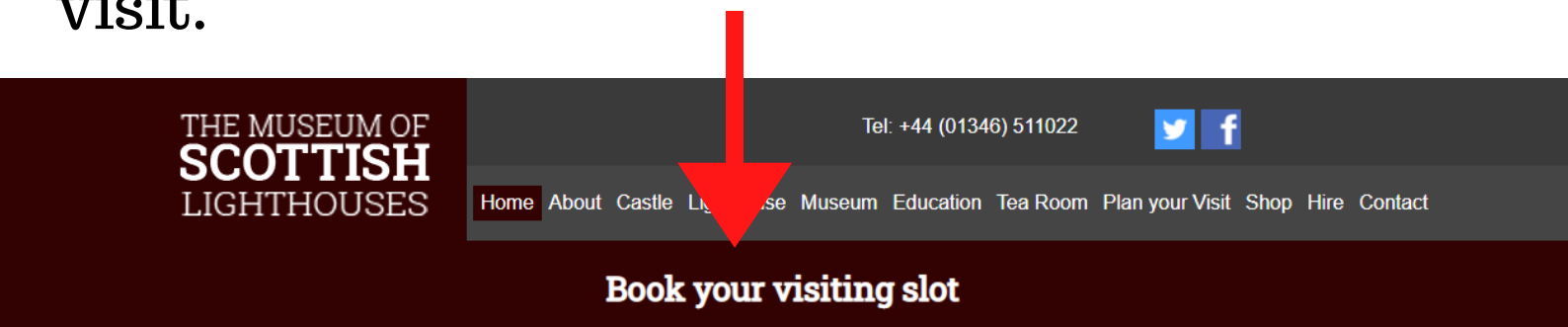

www.lighthousemuseum.org.uk

2. Your tour guide will meet you at the front door! So you won't need to go inside at this point. They will check your receipt so don't forget to bring it with you!



3. We prefer it if you wear a face covering for the tour but we understand you might not like to.



4. Your tour guide will be wearing a face covering at all times. This is to protect everyone.



Michael S.



Michael C.

5. Your tour guide will stay 2 metres away from you at all times. This is to protect everyone.

6. When your tour of the lighthouse is over, your tour guide will take you back to the museum. Use the hand sanitiser as you come in the door!



7. You will go round the museum in your group without a tour guide. The Museum will be marked out to help keep your 2 metre distance.



8. The Museum will be a one way system but the arrows on the floor will show you the way to go.



9. We would prefer it if you wore a face covering in the museum if you are comfortable doing so.



Museum Shop

Our Museum has a shop with things you can buy if you want to!

The shop also has lines to follow and our shopkeeper will be behind a Perspex Screen.

We have a new rule in the shop that you should not pick anything up unless you are buying it. This is to help stop the spread of infection.



Museum Cafe

Our Museum Cafe will be open to Museum Visitors. We would prefer it if you wore a face covering until you are seated.

It is table service, so just take a seat at a table marked with a picture of a green flag. If you see a picture of a red flag, do not use that table as it required disinfecting.

We would prefer payment by contactless to save handling money. This can be done at the Perspex screen.



Staff

When you visit our Museum here are some of the staff you will see. Remember they may also be wearing visors.



Lynda
Museum Manager



Michael S.
Tour Guide



Michael C.
Tour Guide



Shaun
Cafe Assistant



Lesley
Cafe Assistant

Sensory Map: Ground Floor

Some areas of the Museum are not open to the public. These are red on the map.

Other areas can be very noisy, like the AV Room. Areas where you might find it noisy have a yellow triangle beside them.

Green doors can only be used if the fire alarm sounds.

The Designated Chill Out Zone for the Museum is in the Exhibition Area.

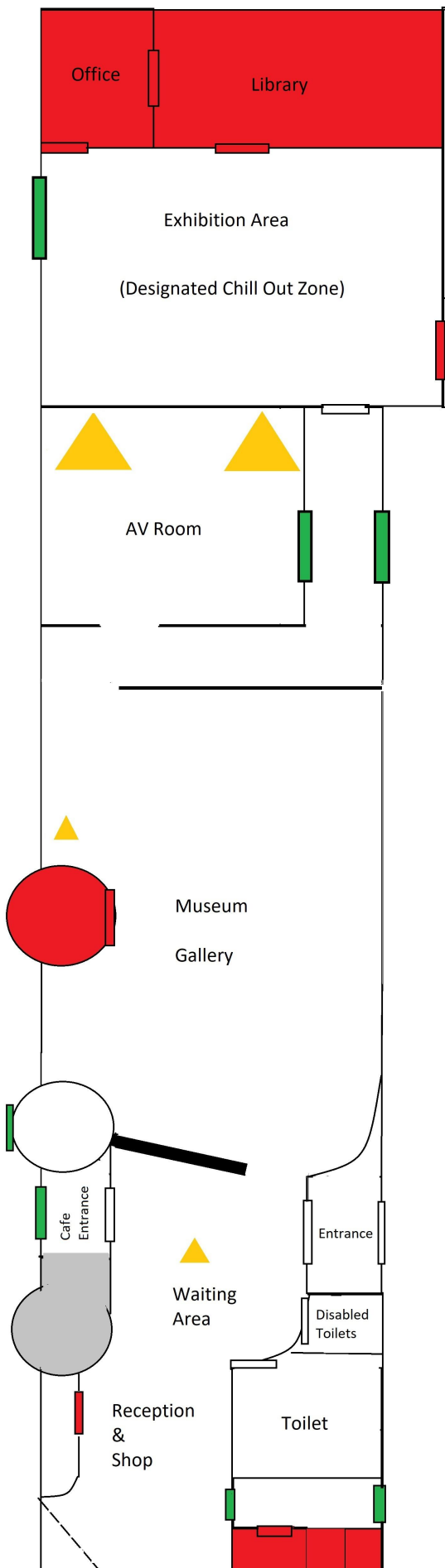

- Emergency Fire Exit Only
- Door
- Stairs
- Noise!
- No Access to Visitors

Sensory Map: First Floor

The upper galleries of the museum are accessed by a gradual stairs.

In between the galleries there is a sound recording playing.

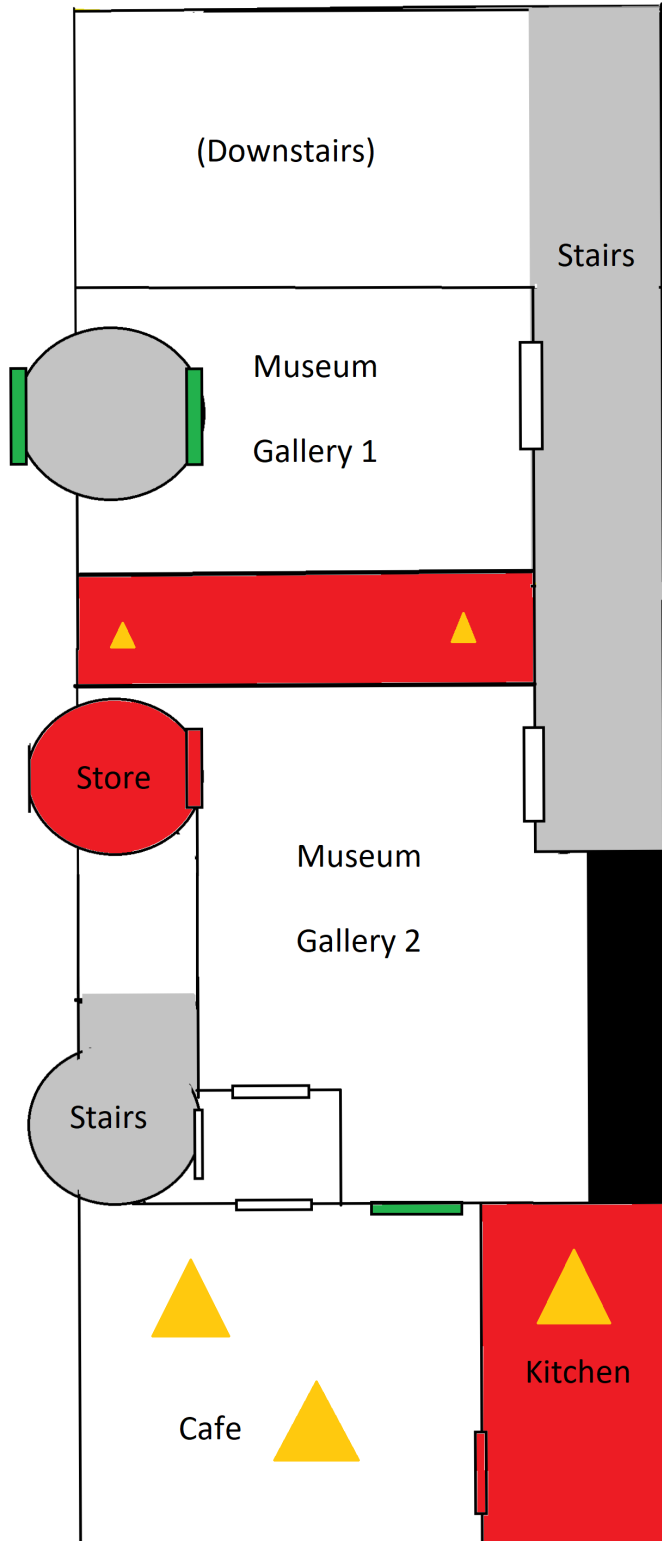

- Stairs
- No Access
- Fire Exit
- Doors
- Noise

How to Find Us!

Some Directions:

A90 (Aberdeen Road):

Take third exit on the first (Tesco) roundabout on to South Harbour Road. Follow the Road past the beach, and harbour to Shore Street. Keep left at the end of Shore Street onto Bath Street. This will lead you to Quarry Road. Follow Quarry Road until its end, and turn right to the Museum.

A981 (Strichen Road):

On entering Fraserburgh take second exit on first roundabout onto Strichen Road. Follow the length of Strichen Road (where the War Memorial is) and turn left at the junction onto Saltoun Place. Follow Saltoun Place onto Cross Street, and turn left at the traffic lights beside Farmfoods. Take second right onto Denmark Street and follow to its end, then turn left to the Museum.

A98 (Banff Road):

Follow the A98 on to Watermill Road (Straight ahead past Asda). Follow this long Road until you can take a left turn onto Denmark Street. Follow Denmark Street to its end, and turn left to the Museum.

By Bus: X67 and X68 from Aberdeen is the main service.

Get off at Bus Station at Hanover Street. You will see a 'Wimpy' turn left before the Wimpy until you find Caroline Place. Cross the road onto Barrasgate Road. Keep walking until you see Park Street, then turn left. Take a right onto Denmark Street which will lead to the Museum. This is about 5 minutes walking distance.

How to Find Us!

If you are coming to visit the Museum we have prepared map to show you the best way to find us!

